

MINERAL WOOL CORE WALL SANDWICH PANELS WITH CONCEALED FASTENING

BALEXTHERM-MW-W-PLUS

FEATURES

- high fire resistance - can be used as fire divisions
- high fire tightness - unique, both-sided shape of the panel-and-lock joint
- easy assembly - sloping of the internal joint surface, longwise groove facilitates positioning of fasteners
- compatible system - panels matching the BALEXTHERM-W-PLUS panels with various core materials
- high strength - specially prefabricated mineral wool core
- high durability of anti-corrosion coatings - appropriate technology for profiling the shape of metal facing
- aesthetic façade appearance - concealed structural joint, wide range of profiles and colours of external facing
- environment friendly - hard mineral wool is not hazardous to the natural environment

APPLICATION

- exterior walls
- partition walls
- interior flooring covering
- structure insulation
- commercial and industrial facilities of elevated fire resistance requirements
- logistic facilities
- office facilities
- agricultural facilities
- fruit and vegetable stores
- sport halls

TECHNICAL PARAMETERS

Name	Mineral wool core wall sandwich panels with concealed fastening (BALEXTHERM-MW-W-PLUS)									
Core	hard mineral wool (nominal apparent density 110 kg/m ³)									
Facing thickness [mm]	0,50 - 0,70									
Steel grade	S250GD									
Coatings	SP polyester, matt pearl SP polyester, matt HDP polyester, PVC(F) „foodsafte“, PVDF, galvanized, alu-zinc + easyfilm®									
Colouring	wide range of Balex Metal colours – page 46									
Effective width [mm]	1 050									
Total width [mm]	1 100									
Panel length [mm]	2 500 - 18 000									
Core thickness [mm]	80	100	120	130	140	150	160	180	200	
Panel weight [kg/m²]	17,79	19,80	21,90	23,00	24,00	25,01	26,10	28,20	30,30	
Thermal transmittance U_c [W/m²K]	0,48	0,38	0,32	0,30*	0,28	0,26	0,24	0,22	0,20	
Fire resistance	NRO**	NRO, EI 30***	EI 60, Not spreading fire NRO							
Reaction to fire	A2-s2.d0									

* The BALEXTHERM-MW-W-PLUS panel with 130 mm thick core meets the minimal requirements related to the heat transfer coefficient for walls specified in the Ordinance of the Minister of Infrastructure

** Not spreading fire NRO

*** EI 30, Not spreading fire NRO

TYPES OF FACING PROFILES

L Lined

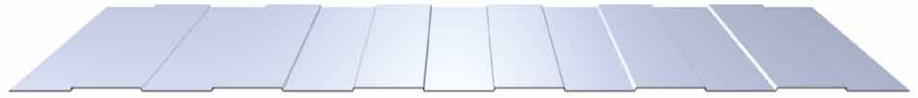

M Microprofiled

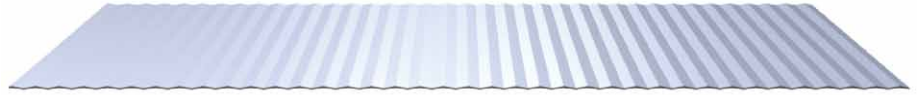

R Grooving



G Flat



AVAILABLE TYPES OF FACING PROFILES

External facing

L **M** **R** **G***

Internal facing

L **G***

* only with 0,60 mm thick facing

SECTIONAL VIEW OF THE BALEXTERM-MW-W-PLUS PANEL

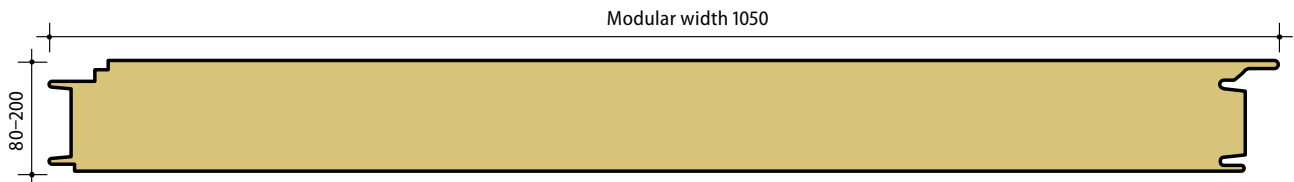

DETAILS OF THE BALEXTERM-MW-W-PLUS PANELS JOINT

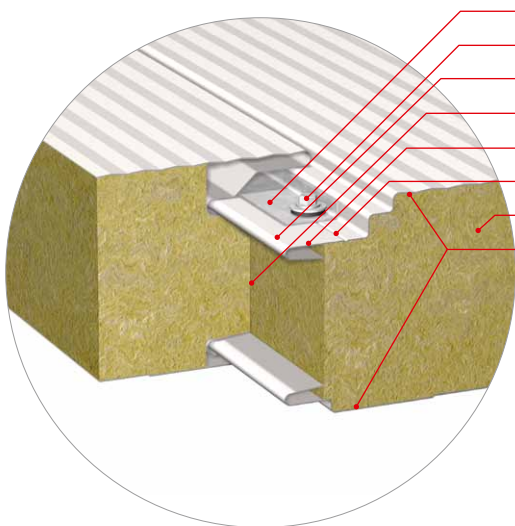

1. steel pad in the panel lock
2. concealed structural joint
3. both-sided shape of the panel-and-lock joint
4. joint of panels
5. conical sloping of the internal joint surface
6. longwise groove facilitates positioning of fasteners
7. mineral wool core
8. profiled external and internal facing