

PERFECT JOINTS

Balextherm panels, regardless of a core type, are equipped with well-fitting locks. This innovative technology permits constructing modern buildings of high technical characteristics.

AESTHETIC ELEVATION

The technology enables making a uniform elevation and roof slope with the use of different insulating materials. For many years Balextherm sandwich panels have been valued for their high quality and wide diversity of profiles. The use of Balextherm panels enables architects and designers to create building structures freely.

INNOVATIVE SOLUTIONS

Balextherm panel utility patterns with polyurethane (PU) core, mineral wool (MW) core and expanded polystyrene (EPS) core are protected by patent. In addition, the new technical solution regarding filling **Balextherm- MW-W-PLUS** and **Balextherm- EPS-W-PLUS** panels' noses with mineral wool granulate was already submitted to the Patent Office.

THE BEST INSULATING PARAMETERS

New **Balextherm** wall panels with mineral wool core of 130mm thick have the same heat insulating parameters as other available on the market sandwich panels with 150mm mineral wool core.

FULL OFFER

Balex Metal offers the complete system of technical solutions for industrial buildings, among other things:

- Finishing elements and accessories
- Rooflights, roof hatches
- Gutter system for mounting on elevation made of sandwich panels - suitable brackets and fastenings







BALEX METAL Sp. z o.o. CENTRAL OFFICE

ul. Wejherowska 12C
84-239 Bolszewo, Polska
Infolinia: 0 801 000 807
tel. +48 58 778 44 44
fax +48 58 778 44 55
kontakt@balex.eu
www.balex.eu

Balex Metal is the biggest manufacturer of sandwich panels in central and eastern Europe. The machines consist of 5 production lines where **10 mln m²** of sandwich panels is produced.

BRANCH OFFICES

-  **CZECH REPUBLIC, BALEX METAL S.R.O., Hradec Králové**, Vázní 1097, tel. +420 495 482 683, fax +420 495 482 683
-  **UKRAINE, BALEX METAL TOV, Kiev**, 30 Vasilkovska, office 4-03, tel. +380 44 39 07 144, fax +380 44 39 07 145, ukraine@balex.eu
-  **LITHUANIA, BALEX METAL UAB, Vilnius**, Savanoriu 174A, tel. +370 527 30 299, fax +370 527 30 295, lietuva@balex.eu
-  **SLOVAKIA, BALEX METAL, Banská Bystrica**, Partizánska cesta 94, 974 01, tel./fax +421 48 419 75 27, slovensko@balex.eu
-  **LATVIA, SIA „BALEX METAL”, Brocēni**, Liepnieku iela 10, Brocēni, Saldus raj. LV-3851, tel. +371 638 65 886, fax +371 638 07 401, latvija@balex.eu

PANELS IDEAL FOR JOINING



Wicemistrz
Ekspozycji
2008

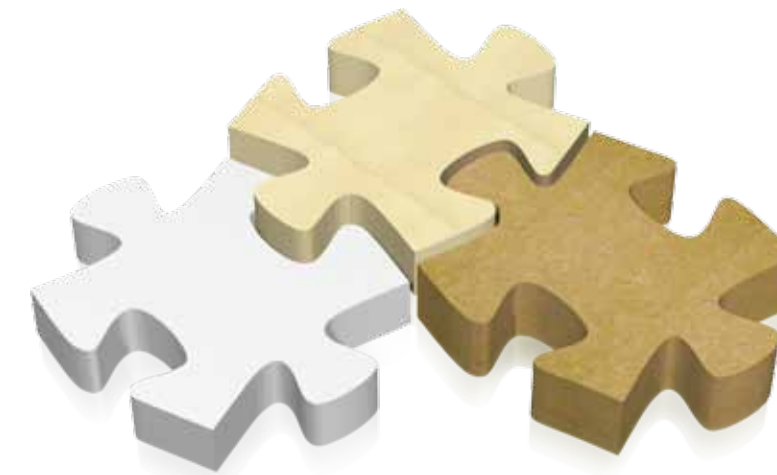

THE CROSS-SECTIONS OF THE NEW BALEXTHERM SANDWICH PANELS

BALEXTHERM MW - WITH MINERAL WOOL CORE



Wall panel with a hidden joint



Standard wall panel



Roof panel

BALEXTHERM PU - WITH POLYURETHANE CORE



Wall panel with a hidden joint



Standard wall panel



Roof panel

BALEXTHERM EPS - WITH EXPANDED POLYSTYRENE (EPS) CORE

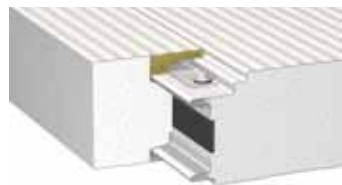

Wall panel with a hidden joint



Standard wall panel



Roof panel

INNOVATIVE TECHNICAL SOLUTION

The wide selection of Balextherm panels meant for construction of walls and roofs permits joining different insulating materials and maintaining the uniform look of a building elevation. The figures below show some example joints.

WALL PANELS BALEXTHERM-W-PLUS WITH A HIDDEN JOINT



WALL PANELS BALEXTHERM-W-ST AND COLD STORAGE PANELS BALEXTHERM-F



ROOF PANELS BALEXTHERM-R



TECHNICAL DATA

DESIGNATIONS USED IN PANELS

BALEXTHERM	MW / PU / EPS	W / R / F	ST / PLUS
Name	core types <ul style="list-style-type: none"> • mineral wool (MW) • polyurethane (PU) • exp. polystyrene (EPS) 	application <ul style="list-style-type: none"> • wall – WALL (W) • roof – ROOF (R) • cold storage-FREEZING (F) 	panel types <ul style="list-style-type: none"> • standard (ST) • with hidden lock (PLUS)

For example: Balextherm-MW-W-ST means standard wall panel with a hidden lock and with mineral wool core.

BALEXTHERM PANEL WIDTH

	Effective width	Total width
BALEXTHERM-W-ST	1100 mm	1120 mm
BALEXTHERM-W-PLUS	1050 mm; 1000* mm	1100 mm; 1050* mm
BALEXTHERM-R	1000 mm	1090 mm

* Available only with polyurethane core – Balextherm-PU-W-PLUS

THE THICKNESS OF BALEXTHERM-W-ST / BALEXTHERM-W-PLUS PANELS

BALEXTHERM-W-ST / BALEXTHERM-W-PLUS	40	50	60	80	100	120	130	140	150	160	180	200
EPS - exp. polystyrene				•	•	•	•	•	•			•
MW - mineral wool				•	•	•	•	•	•			•
PU - polyurethane	•*	•*	•	•	•	•**				•**	•**	•**

* Only Balextherm-W-ST panels, ** Only Balextherm-F panels

THE THICKNESS OF BALEXTHERM-R PANELS

BALEXTHERM-R	40	60	80	100	120	150	160	180	200
EPS - exp. polystyrene				•	•	•	•	•	•
MW - mineral wool				•	•	•	•		
PU - polyurethane	•	•	•	•	•				

MINERAL WOOL (MW)

POLYURETHANE (PU)

EXPANDED POLYSTYRENE (EPS)